

HUS-HR	h_1	t_{fix}
10x75	$85\text{ mm} - t_{fix}$	0...5 mm
10x85	$95\text{ mm} - t_{fix}$	0...15 mm

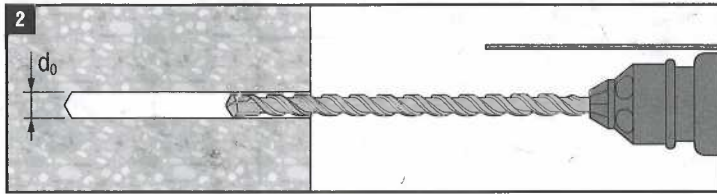

2.1	Concrete Type	Drill Bit	Diameter
	Lightweight aggregate concrete	SIW 22-A	Ø 10 mm
	Normal weight concrete	SIW 22-T-A	Ø 10 mm
	High-strength concrete	SI 100	Ø 8 mm

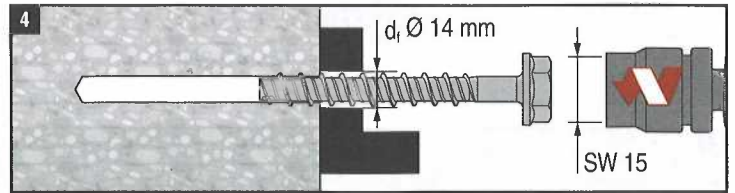
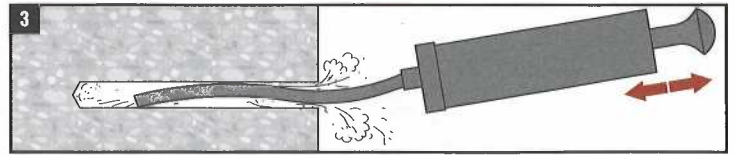

4.1	Concrete Type	SIW 22-A	SIW 22-T-A	SI 100	Torque
	Lightweight aggregate concrete	⊘	⊘	⊘	45 Nm
	Normal weight concrete	✓	⊘	⊘	20 Nm
	High-strength concrete	✓	⊘	⊘	10 Nm

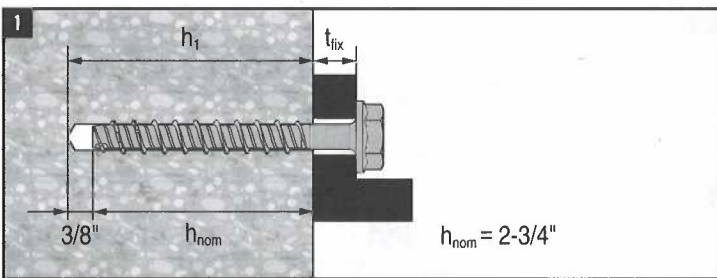
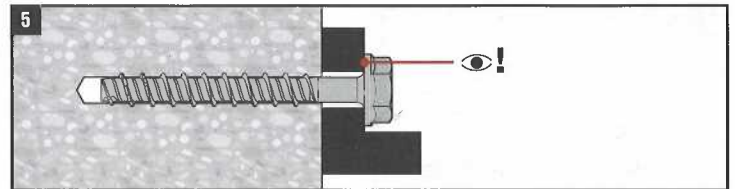

HUS-HR 10	h_1	t_{fix}
10 x 75	$3\text{-}3/8\text{''} - t_{fix}$	0"...3/16"
10 x 85	$3\text{-}3/4\text{''} - t_{fix}$	0"...9/16"

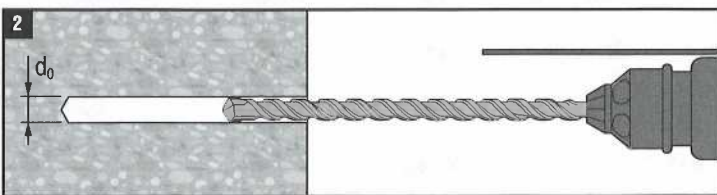

2.1	Concrete Type	Drill Bit	Diameter
	Lightweight aggregate concrete	SIW 22-A	Ø 10 mm

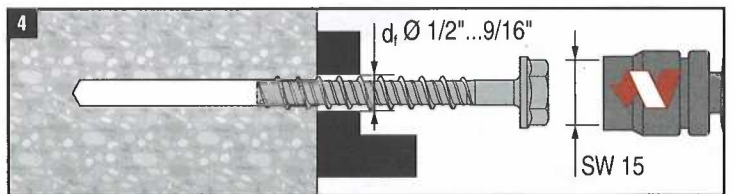
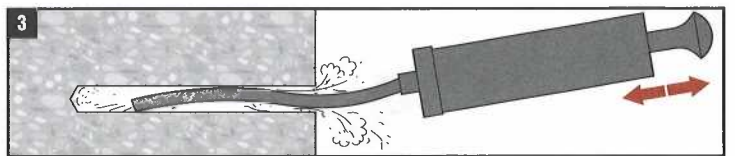

4.1	Concrete Type	SIW 22-A	SIW 22-T-A	Torque
	Lightweight aggregate concrete	✓	✓	33 ft-lb

