

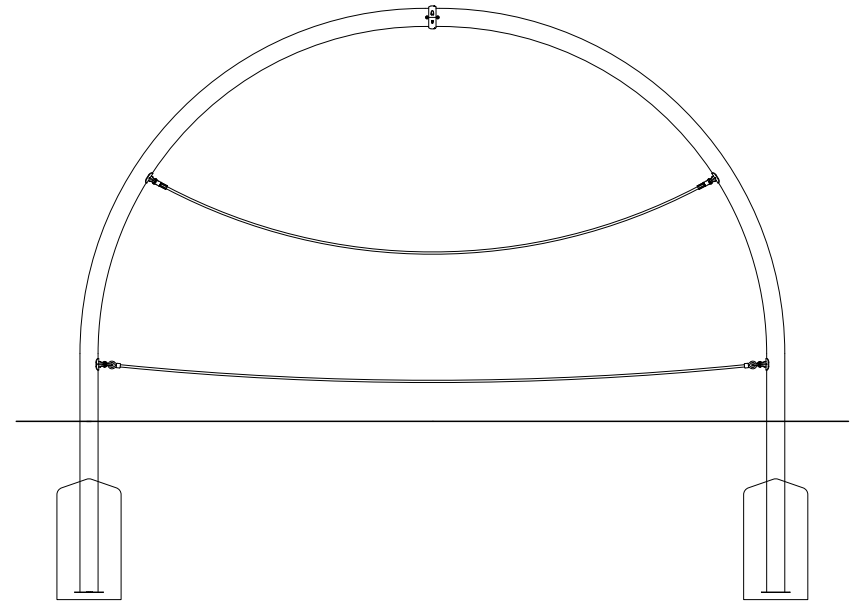









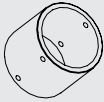

CC & BM

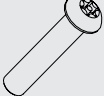
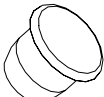
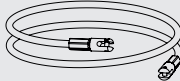
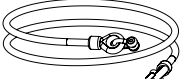

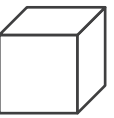
1	78603012		x2	51Kg	4800x 1310 x 200mm
2	78604001		x1	2.2g	Ø118 x 100mm
3	10291000		x4	0.002Kg	M10_B_Ø11 x Ø21 x 1_A2
4	10121030		x4	0.03Kg	M10 x 30_A2_TX45
5	78804306		x2	0.27Kg	5" - 163 x 84 x 51
6	14104749		x2	0.01Kg	1/4" UNC x 1-1/4"
7	19055030		x2	0.001Kg	Ø11.5 x 9.5
8	78805029		x1	1.6Kg	Ø16mm x 4056mm
9	78805061		x1	1.7Kg	Ø16mm x 4580mm
10	78804031		x1		

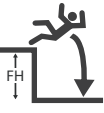
S12  kg 108	S15  L x W x H (m) 4.94 x 0.13 x 2.91	S13  m³ 0.35	S14  m² 10 x 10
S6  EN1176 0.4m	S20  2 x 6	S24  10121000 - TX45	

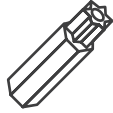
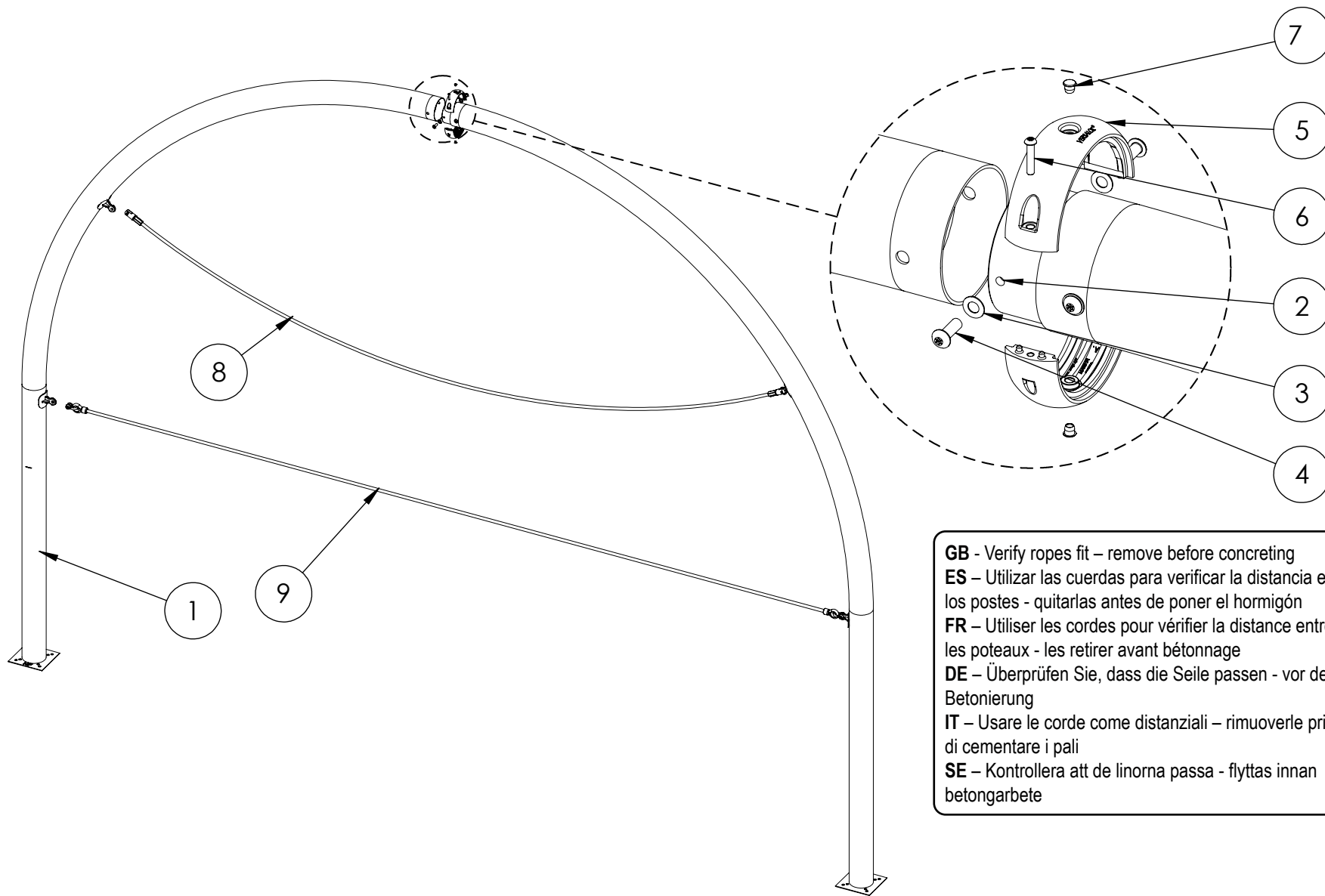



GB - Verify ropes fit – remove before concreting
ES – Utilizar las cuerdas para verificar la distancia entre los postes - quitarlas antes de poner el hormigón
FR – Utiliser les cordes pour vérifier la distance entre les poteaux - les retirer avant bétonnage
DE – Überprüfen Sie, dass die Seile passen - vor der Betonierung
IT – Usare le corde come distanziali – rimuoverle prima di cementare i pali
SE – Kontrollera att de linorna passa - flyttas innan betongarbete

S25



S2 (50mm)
≥C20-25

 7 x 24h

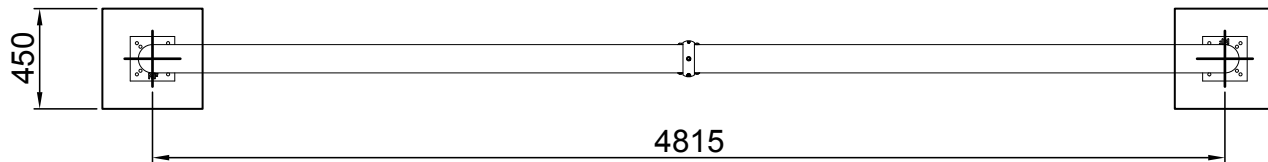
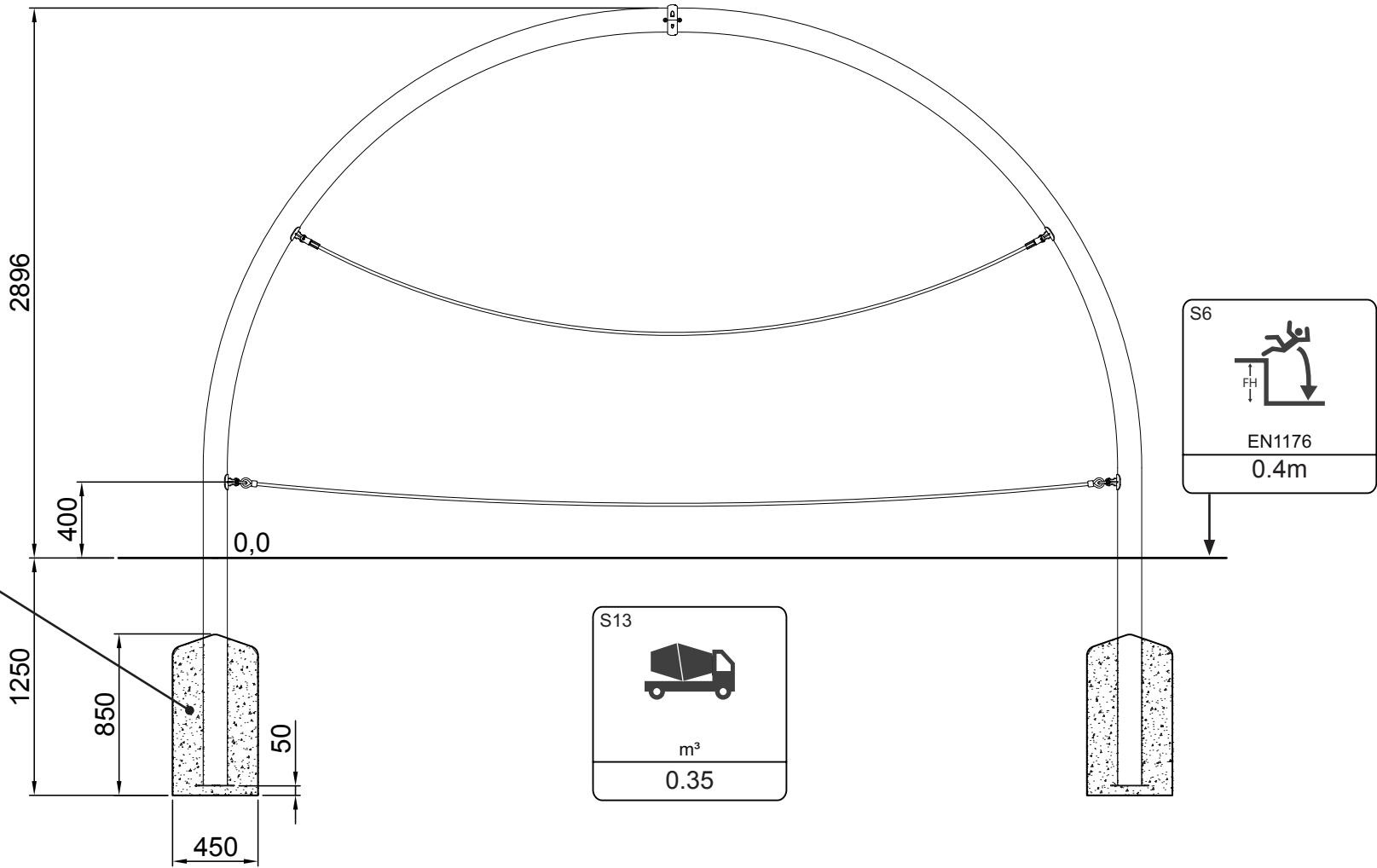
 101

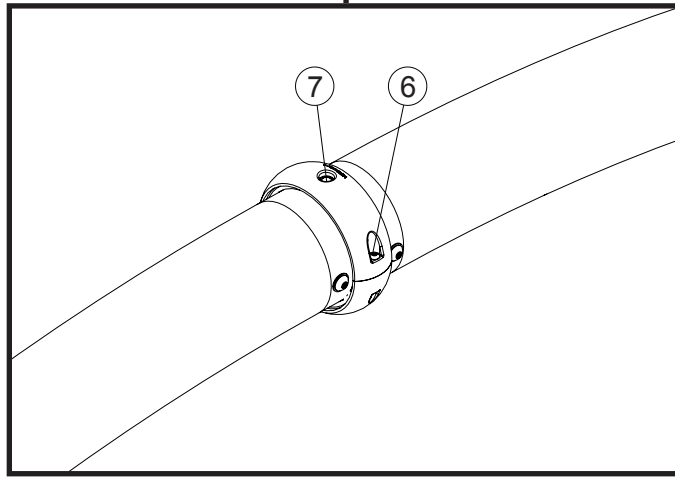
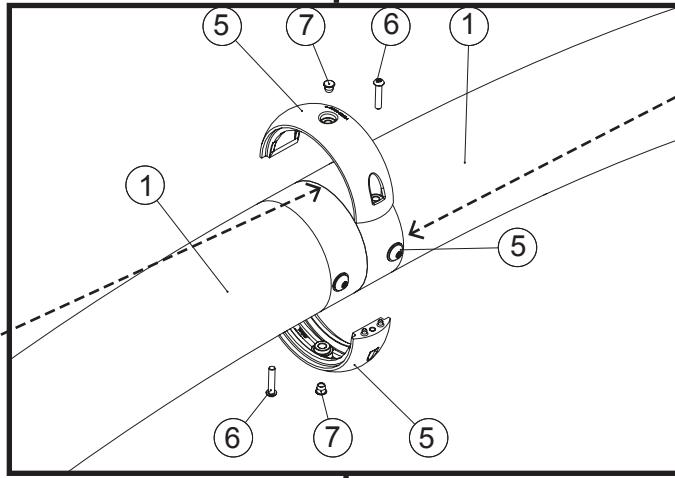
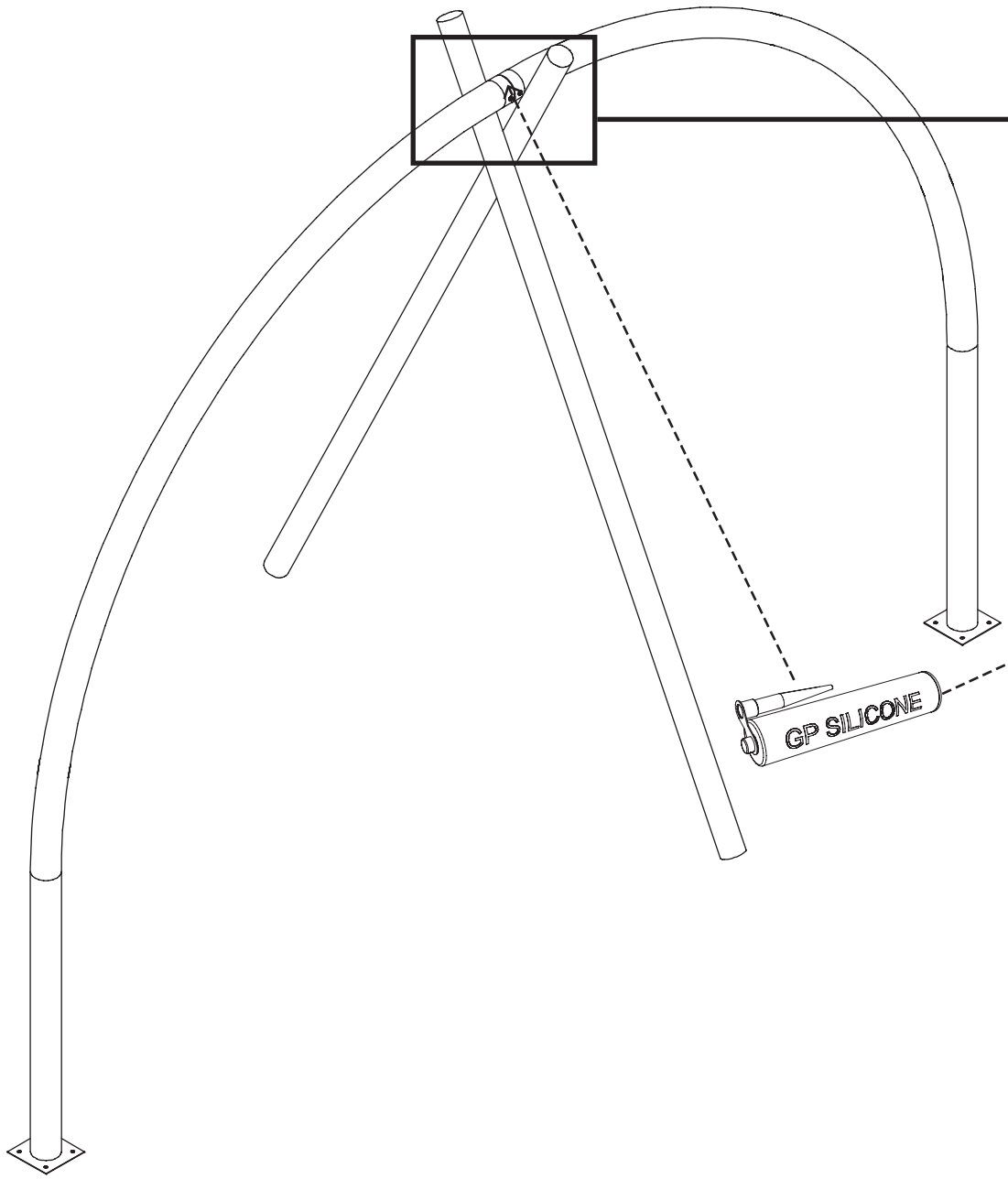

S11



Nm
20-25

