

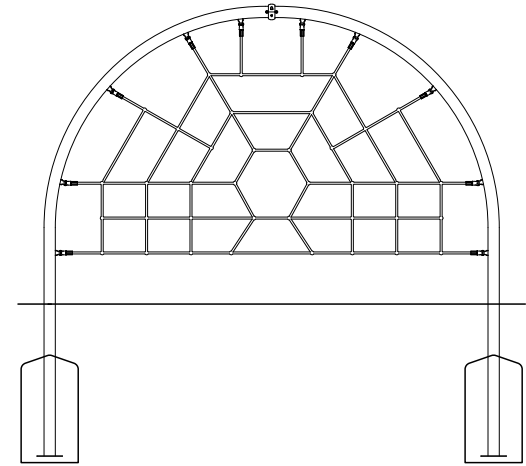

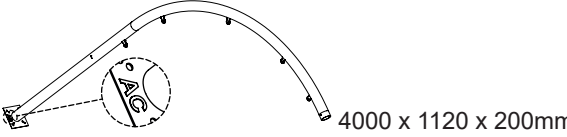

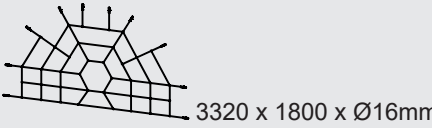

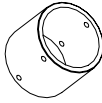

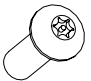

CC & BM

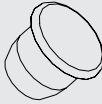

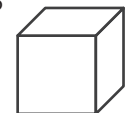
1	78603019		x2	30Kg
2	78805051		x1	12kg
3	78604002		x1	1.6kg
4	10291000		x4	0.002Kg
5	10121030		x4	0.03Kg
6	55030799		x2	0.21Kg
7	14104749		x2	0.01Kg
8	19055030		x2	0.001Kg
9	78804031		x1	

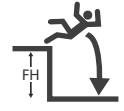
S12  kg 74	S15  L x W x H (m) 3.58 x 0.09 x 2.37	S13  m ³ 0.35	S14  m ² 10 x 10
S6  EN1176 2.4m	S20  2 x 6	S24  10121000 - TX45	

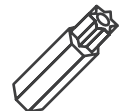
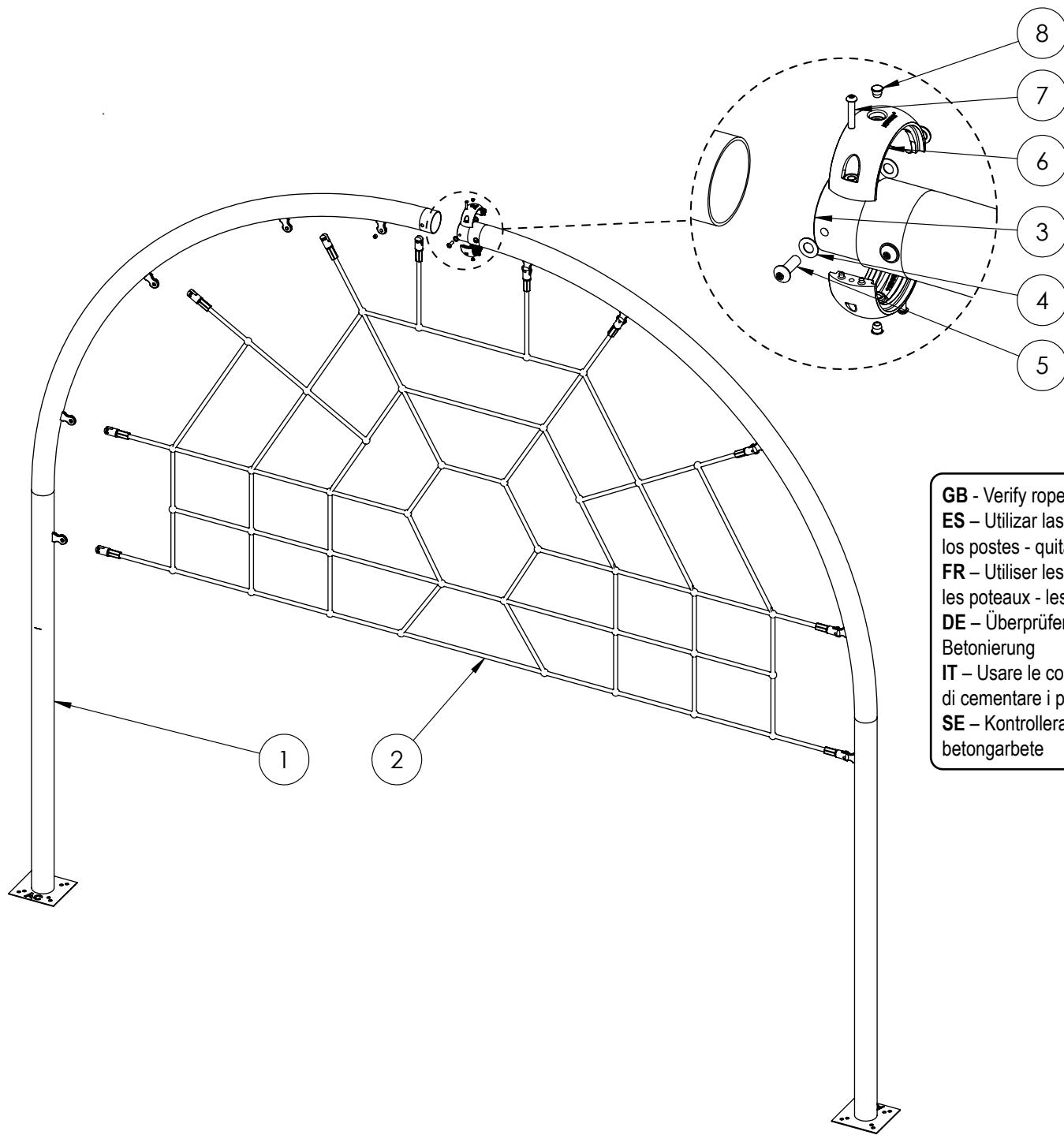

GB - Verify ropes fit – remove before concreting
ES – Utilizar las cuerdas para verificar la distancia entre los postes - quitarlas antes de poner el hormigón
FR – Utiliser les cordes pour vérifier la distance entre les poteaux - les retirer avant bétonnage
DE – Überprüfen Sie, dass die Seile passen - vor der Betonierung
IT – Usare le corde come distanziali – rimuoverle prima di cementare i pali
SE – Kontrollera att de linorna passa - flyttas innan betongarbete

S25



S2 (50mm)
≥C20-25

 7 x 24h

Eye icon 101

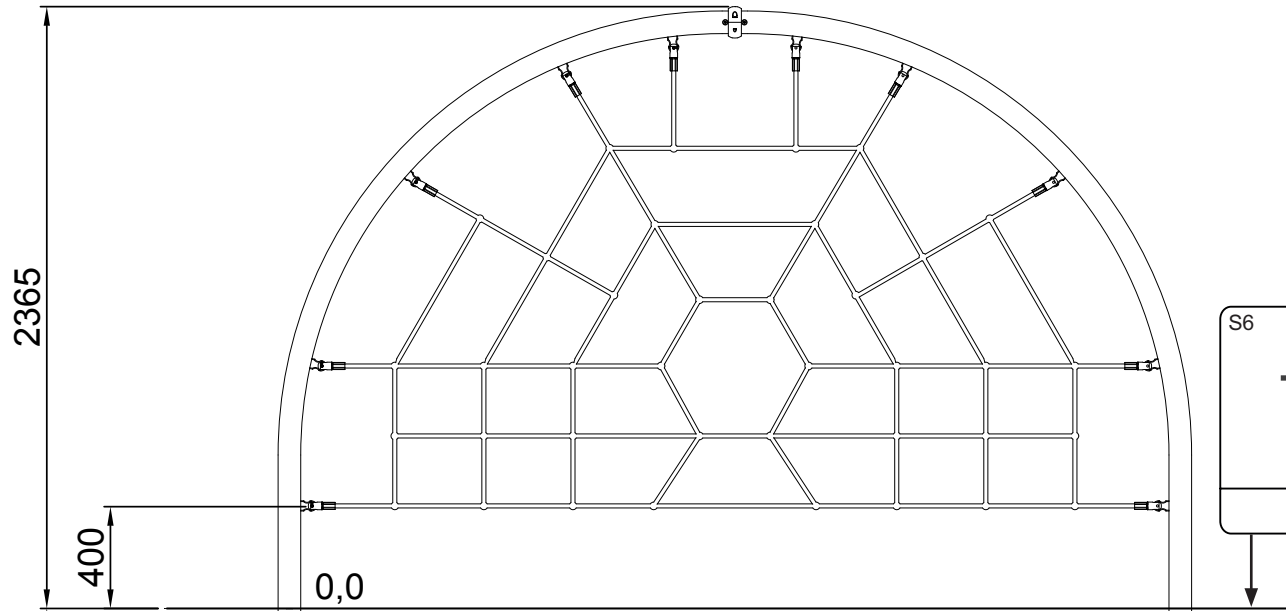

S6

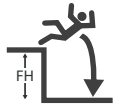

EN1176
2.4m

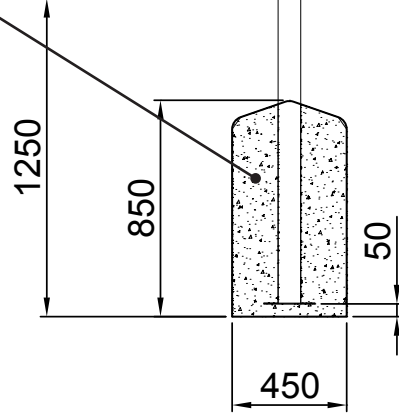

S13



m³
0.35

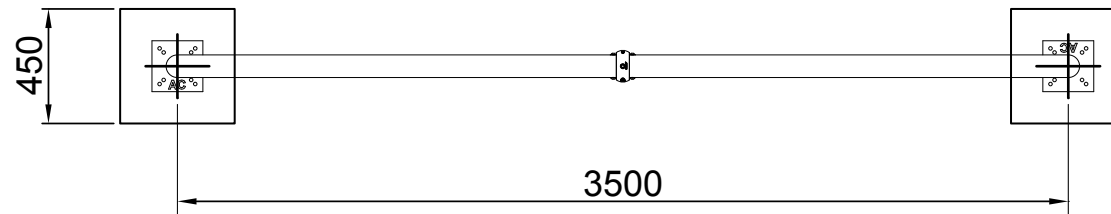
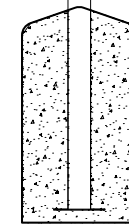

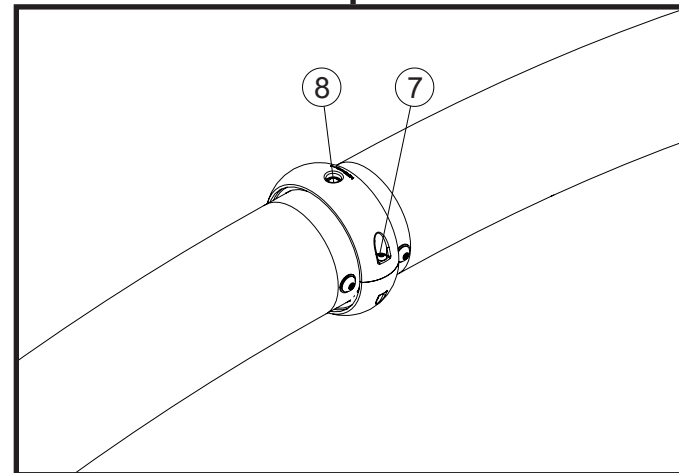
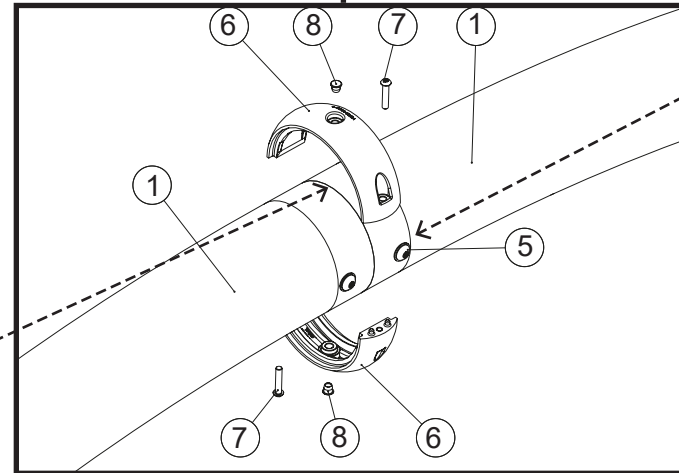
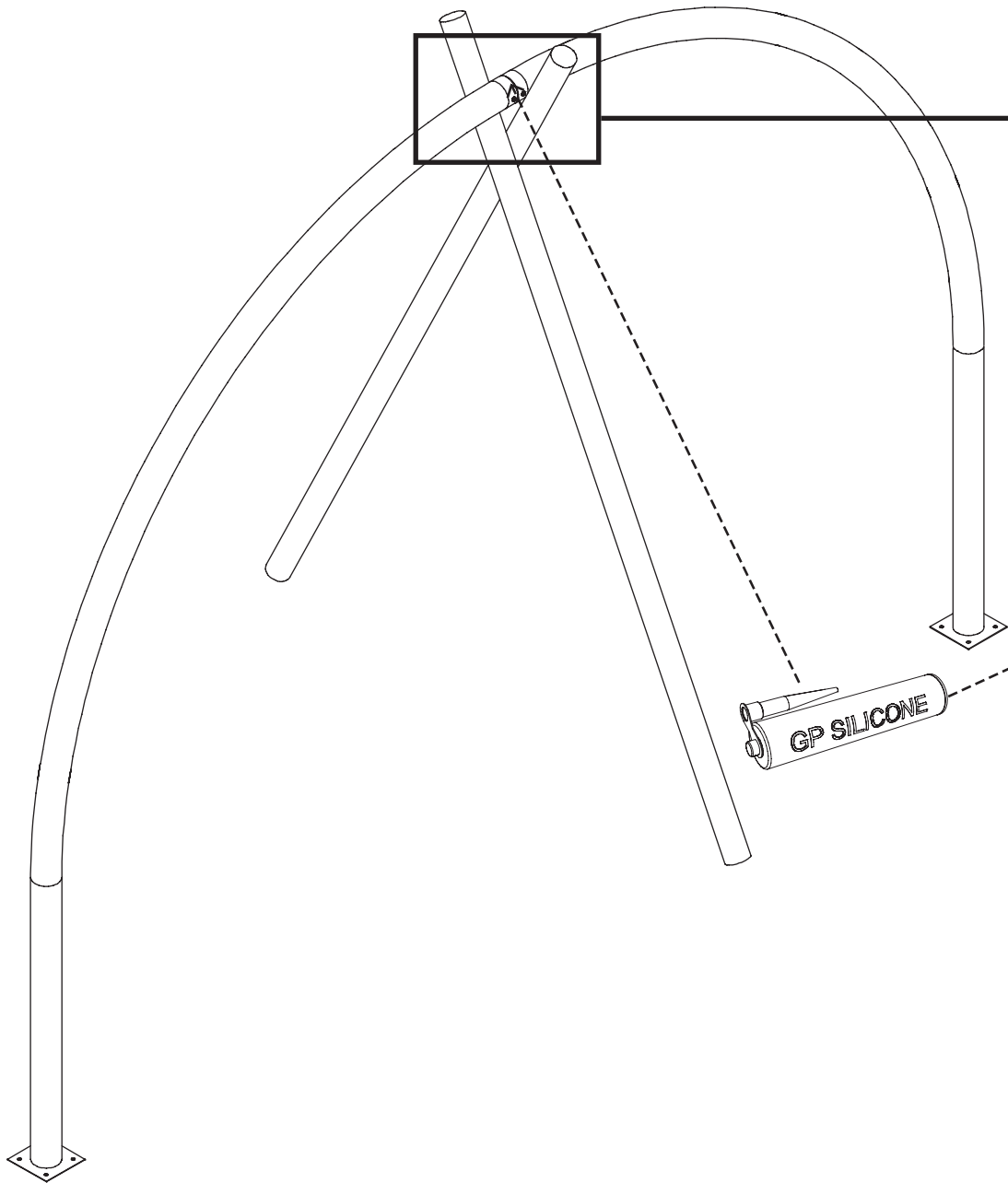

S11



Nm
20-25

